

BALTIMORE
THE IVY
HOTEL



HISTORY OF THE IVY

In 1889, John Gilman, prosperous banker and industrialist, commissioned a mansion in Mount Vernon, Baltimore's most prestigious neighborhood. He chose architect Charles Carson for the job, a master of design who had recently completed Baltimore Grand Masonic Venue and the opulent Methodist Church. Gilman asked Carson to build him a house to speak of wealth, power and taste, from its inlaid floors to its turreted slate roof. But Gilman also wanted a home. Its rooms should be intimate, its fireplaces welcoming, and its tall windows should frame the charming streetscape.

The mansion was raised on the leafy corner of Biddle and North Calvert Streets, neighbored on all sides by handsome brick and stone residences. But as fate would have it, Gilman did not live to enjoy his new home, dying suddenly just before the house was complete. Mrs. Gilman lived at the the Biddle Street mansion for several years, then sold it to a man named William Painter, and his amiable wife, Harriet. William was a wildly successful inventor, a holder of more than 100 patents, and the founder and president of the Crown Cork & Seal Co., manufacturer of bottle caps, corks and closures of all kinds.





The Painters were very sociable and philanthropic, hosting luncheons and bridge parties, dedicating parks and statues. The Painters and their three children divided their time between the house on Biddle Street and an opulent summer home in Guilford. Father and son were great fans of the work of Baltimore native Edgar Allan Poe, and made sure to send birthday flowers to his grave every year.

When William passed on, Harriet built a children's hospital in his name in the city. Soon afterwards, she sold the mansion to the Futchers family. Dr. Futchers was a Canadian physician, a noted diagnostician recruited to join Johns Hopkins, and he set up office and family in the Biddle Street house. The Futchers lived and worked there quietly for years. The Great Depression rolled in, the neighborhood changed, and the mansion was bought by Robert Garrett, longtime chairman of the Baltimore Parks and Recreation Department, who in turn gave it to the city for the department's offices. Finally, in the early 1980s, Mayor William Schaefer decided to use the empty – but still beautiful – house for hosting visiting dignitaries.

Today, after an extraordinary update and total rehabilitation, the house is as grand and glorious as ever: garlanded in ivy, high windows shining, turrets rising above the trees and gardens blossoming below. The attention lavished upon it more than a century ago by architect Charles Carson is today evident at every turn, from its Tiffany-leaded glass windows to its carved wood wainscoting, 23 individual fireplaces, green marble mined from local quarries, and a magnificent central staircase that climbs three stories past stained glass toward the radiance of the original skylights at the top, like an ascent to heaven.





GUEST SERVICES

Although every one of The Ivy team will be delighted to answer questions and fulfill requests, the Guest Service staff are especially well-prepared to do so. Twenty-four hours a day a friendly and knowledgeable person can be found at the Concierge Desk, located on the first floor at the base of the grand staircase, and will provide information about or assistance with any of the areas below. Call 201 from your room phone or visit in person, the concierge will be happy to hear from you.

BABYSITTING AND CHILD AMENITIES

We can help make traveling with your children a happy and enjoyable experience for the whole family, from developing a personalized itinerary from Baltimore's myriad attractions and destinations, to arranging a babysitter, to acquainting you with our selection of children's toys, books, meals, snacks, and activities. Rollaway beds, cribs, and other equipment are available.

BUSINESS SERVICES

We can provide printing, photocopying, or scanning upon request. We also have a computer and an iPad available for guests to borrow.

DINING AND ROOM SERVICE

Magdalena, a Maryland Bistro, is located on the Ground Floor of the hotel and easily accessed by elevator or stairs. View the menu, which changes daily, at the restaurant or Concierge desk.

You may order from the Room Service Menu which can be viewed in the menu section. During restaurant hours, dinner from Magdalena can be served in your room.





EMERGENCY

In the event of an emergency, PLEASE DIAL 911 IMMEDIATELY or press the emergency button on the phone in your room. We have several hospitals conveniently located close to the hotel including Union Memorial Hospital, University of Maryland Medical Center, Mercy Hospital, and Johns Hopkins Hospital.

FITNESS ROOM

Our exercise room is located on the ground floor and is available for use 24 hours a day. Take the central elevator to the ground level and turn right upon exiting. A sign will direct you to go through the door and turn left.

Refreshments are located in the small refrigerator in the gym. If you are interested in a personal trainer, we will be happy to arrange a session.

SWIMMING

Swimming pool access is available at the nearby Merritt Downtown Athletic Club, approximately a half mile from The Ivy Hotel. A \$25 pass allows visitors one day use of the entire facility, which also includes squash, racquetball and basketball courts in addition to workout equipment of all kinds.





RECOMMENDED WALKS AND RUNS

Below you will find a map outlining our suggested jogging route from The Ivy Hotel. This route is approximately 2.4 miles (3.8 km) and can be easily modified. It will take walkers or runners south toward the Inner Harbor via N. Charles Street and returns them to the hotel heading north via Calvert Street. Please note that the route south slopes downhill toward the Inner Harbor, so that the return back to the hotel is mostly uphill.

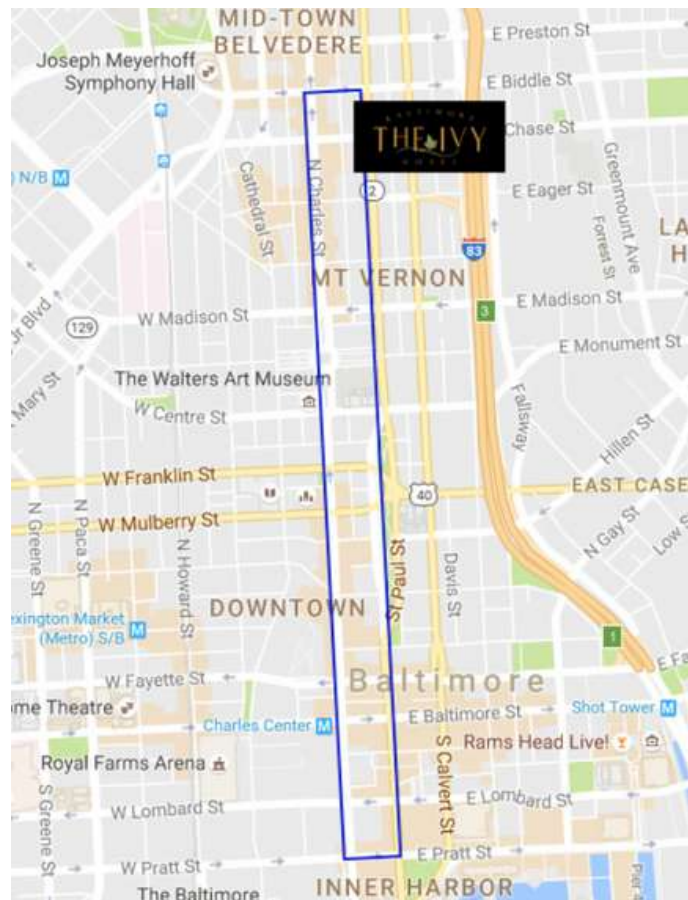

For longer runs, we recommend the 5.2 mile flat brick-lined promenade around the Inner Harbor, from which you can enjoy views of boats and water. The mileage can be increased by running down each of the piers. Early morning or evening are the best times to avoid crowds, especially in the summer.

Another shorter option is to walk or run west on Biddle Street, turning left on North Charles Street and continuing down to the Washington Monument, then left again to return to the hotel via Calvert Street. This path is approximately 1.3 miles (2.1 km).





FLORAL ARRANGEMENTS

We can organize floral arrangements for any occasion with a 24 hour notice.

HOUSEKEEPING

Your room will be serviced morning and evening, though special requests can be accommodated at any time of the day. For your convenience, there is a “Do Not Disturb” sign on the inside doorknob.

LAUNDRY

Wash and Fold services and Same Day Pressing are complimentary.

MEDICAL SERVICES

Please call if you need the services of a physician or dentist, or if you have a medical appointment and need transportation.

PARKING & VALET

Valet services and parking in our nearby secure, locked parking facility are complimentary, and available between 7am-10:45pm. Advise us when you need your car, and it will be brought to the 205 East Biddle Street entrance.

If you are expecting a visitor who will need valet service for a car, please let us know the name, vehicle type, and approximate arrival time of the party.





RELIGIOUS SERVICES

Those listed below are in the immediate Mount Vernon area, but should you be interested in another religion or denomination, just ask.

GREEK ORTHODOX

Annunciation Cathedral: 24 W. Preston St. 410-727-1831

Sunday Orthros: 8:45am

Sunday Divine Liturgy: 10:00am

Weekday Feasts Orthros: 9:00am

Weekday Feasts Divine Liturgy: 10:00am

PROTESTANT

Mt. Vernon Place United Methodist Church: 10 East Mt. Vernon Place, 410-685-3404

9:15am Joys and Concerns - Prayer

9:30am Adult Bible Study

10:30am Children's Sunday School

10:30am Worship Service

11:30am Fellowship Hour

First and Franklin St. Presbyterian Church: 210 W. Madison St. 410-728-5545

Sunday Service: 10:30am

St. Paul's Episcopal Church (Old St. Paul's): 233 N. Charles St. 410-685-3404

Sunday Worship: 8:00am

Choir & Children's Worship: 10:30am

Wednesday: 12:00pm

UNITARIAN UNIVERALIST

First Unitarian Church of Baltimore: 12 W. Franklin St. 410-685-2330

11:00 AM Sunday Service, Sunday School, and Nursery available

July through August services held in Enoch Pratt Parish Hall





ROMAN CATHOLIC

Basilica of the Assumption: 409 Cathedral St. 410-727-3564

Monday - Friday Mass: 7:30am and 12:10pm

Saturday Mass: 5:30pm (Vigil for Sunday)

Sunday Mass: 8:00am, 10:45am & 4:30 pm

St. Ignatius Catholic Church (Jesuit): 740 N. Calvert St. 410-727-3848

Saturday: Daily Mass: 12:10pm (Chapel), Vigil Mass: 4:30 pm (Chapel)

Sunday: Early Mass: 8am (Chapel, no music), Radio Mass: 9:00am, Main Mass: 10:30am (Church), Professional quartet, organist and cantor; Children's Liturgy: Family Choir Mass, Evening Mass: 6:00 PM (Church)

Daily Mass: 7:25 AM and 12:10 PM (Chapel)

THE SPA AT THE IVY

The Spa at The Ivy is located on the second floor of the hotel, though a massage in the privacy of your room can certainly be arranged. For more information, please contact The Spa by calling 214 on your phone, or refer to the compendium section labeled Spa at The Ivy for more information about the services offered.

TRANSPORTATION SERVICES

As part of The Ivy Hotel's highly inclusive stay, guests have complimentary access to our private car services within an approximate three mile radius of the property. Please let us know if you'd like a ride.

We can also coordinate transportation with a town car and driver to destinations in the greater Baltimore/Washington D.C. metropolitan area and beyond; please contact the Concierge for rates and to organize a trip.





IN-ROOM TECHNOLOGY

INTERNET ACCESS

Guest Wifi Network: theivyhotel_guest
Wifi Password: 205ebiddle

THERMOSTAT CONTROLS

Our state-of-the-art HVAC System constantly circulates fresh air into the hotel. To change the room temperature either warmer or cooler, it works best to increase not more than three degrees at a time. For instance, if the temperature in the room is 72 degrees as in the picture below, and you would like it to be, say, 78, please set it to 75, and when the room reaches that temperature, increase it another three degrees.

Please use the red upward facing arrow to increase the room temperature.
To decrease the room temperature, please use the blue downward facing arrow.



LIGHTING

The top button on the light switch pad will control all of the applications in a particular room. Individual lights controls can be found beneath that button to allow you to adjust your room to your ideal setting.



IN-ROOM SAFE

All of our guest rooms are equipped with a safe which can be locked with a secure code chosen by you.

To operate the safe:

- Step 1: Press the “Reset” button located in the lower left corner of the key pad.
- Step 2: Enter the 4 digit code of your choosing (please remember the code you have entered)
- Step 3: Press the “Lock” button located in the lower right corner of the key pad. The safe is now locked and your 4 digit code will be needed to open it.
- Step 4: To open the safe, key in your 4 digit code, and the safe door will open.
- Step 5: The safe will remain responsive to this 4 digit code until the “Reset” button is pressed.

If you have any issues operating the safe, or find that you have locked yourself out of your safe, please contact the Concierge for assistance.

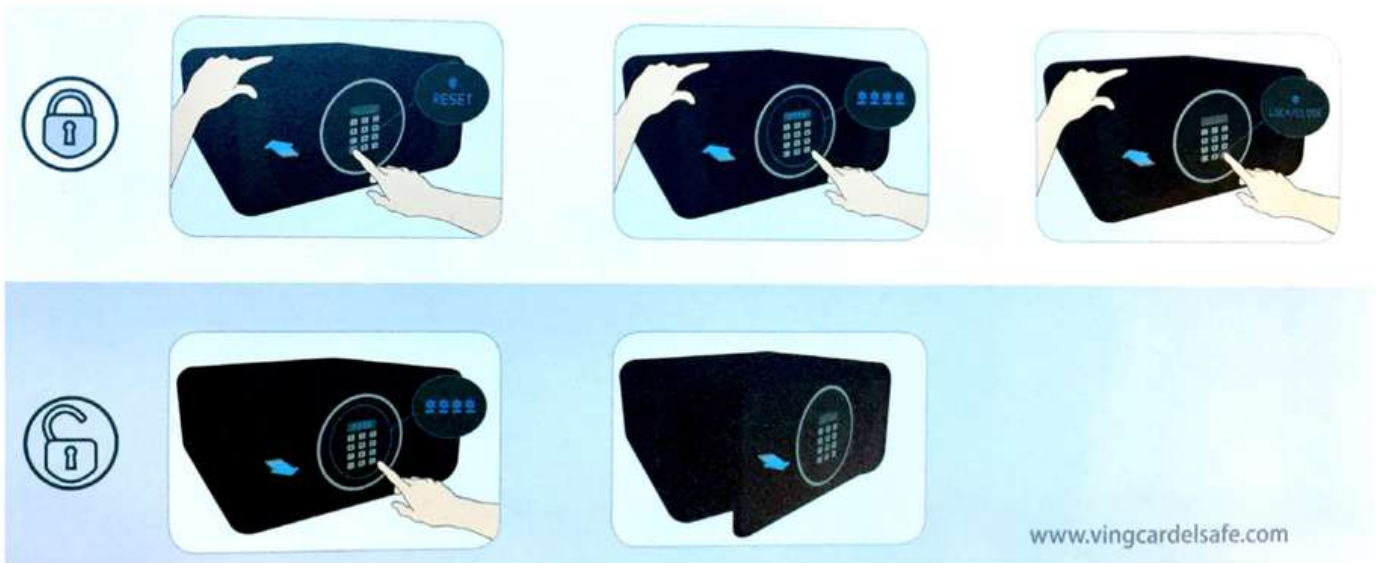



CHANNEL GUIDE

2 ABC	34 Hallmark
3 CBS	35 Hallmark Movie
4 NBC	36 Lifetime
5 FOX	37 Lifetime Movie
6 PBS	38 Animal Planet
7 CW	39 A&E
8 ESPN	40 Comedy Central
9 ESPN 2	41 Discovery Channel
10 ESPN Classic	42 Food Network
11 ESPN News	43 Cooking Channel
12 ESPN U	44 Spike
13 NFL Network	45 AXSTV
14 CBS Sports	46 HD Net Movies
15 NBC Sports	47 HGTV
16 Golf Channel	48 History Channel
17 Tennis Channel	49 Travel Channel
18 NBC	50 National Geographic
19 CNN	51 TBS
20 CNN Headline News	52 TLC
21 Fox News	53 TNT
22 MSNBC	54 Velocity
23 CNBC	55 USA
24 Bloomberg	56 SciFi
25 Weather Channel	57 Universal
26 Cartoon Network	58 HBO
27 Nickelodeon	59 HBO2
28 VH1	60 HBO Comedy
29 MTV	61 HBO Zone
30 AMC	62 The Ivy Hotel
31 E!	99 Movie Trailers
32 Bravo	
33 OWN	



MOVIES/CHANNEL GUIDE

To help you better enjoy your Ivy experience, guests have access to two complimentary Pay PerView movies per stay. The guide on your television will help direct you to select your movie choice.

TELEPHONE

To call another guest room, please follow the guidelines below:

- Room 1 = 101
- Room 2 = 102
- Room 3 = 103
- Room 4 = 104
- Room 5 = 105
- Room 6 = 106
- Room 7 = 107
- Room 8 = 108
- Room 9 = 109
- Room 10 = 110
- Room 11 = 111
- Room 12 = 112
- Room 13 = 113
- Room 14 = 114
- Room 15 = 115
- Room 16 = 116
- Room 17 = 117
- Room 18 = 118

To call locally, please dial 9 + area code + number

To call long distance, please dial 9 + 1+ area code + number



BALTIMORE
THE SPA
AT THE IVY



THE SPA AT THE IVY

The Spa at The Ivy is a small sanctuary on the hotel's second floor, a jewel box of comfort, warmth and well-being. Natural health and vitality are the guiding principles at the Spa. Our product lines, Naturopathica and Restorsea, are leaders in research, development, and innovation. Our treatments and massage expertise will indulge you in an experience both restful and euphoric.

At The Spa at The Ivy, we recognize that every guest is unique. And although we have a treatment menu from which to choose, a simple conversation with your massage therapist, pinpointing your needs and preferences, allows your massage therapist to tailor your treatment for the most beneficial and relaxing experience. You may also bring the spa to your private quarters with an in-room massage. Whether an herbal rub-down after a day of meetings or a beauty blitz before a big event, the therapist's focus is wholly you.

BALTIMORE
THE SPA
AT THE IVY

THE SPA AT THE IVY MENU

The Spa at The Ivy is a beautifully designed luxury retreat right in the heart of Baltimore. Step inside this calming oasis and leave your worries behind. We create each experience to suit your needs, exceed your expectations, and reflect the unspoken wishes of your heart. Like a fine garment, each inspiring treatment is meticulously tailored to match the contours of your body, mind and spirit. Our spa welcomes not only our hotel guests, but outside guests as well.



FACIAL STUDIO

Custom Facial

60 Minutes - \$180 / \$160; 90 Minutes - \$270 / \$240

Our experienced estheticians provide each guest with a complimentary consultation prior to the treatment. Your esthetician will customize the service to address your specific skincare concerns needs and preferences ensuring the best products are utilized to achieve the desired results.

Sensitized Skin Facial

60 Minutes - \$200 / \$180; 90 Minutes - \$295 / \$240

Gentle yet effective treatment for the sensitive skin type or for skin that has been sensitized due to environmental stressors and /or immunocompromisation. This treatment utilizes Restorsea, a product line specifically formulated for the treatment of sensitized skin as well as LED light therapy to assist the body with collagen production, tissue detoxification and healing.

Gentleman's Facial

60 Minutes - \$180 / \$160; 90 Minutes - \$270 / \$240

Specifically created for the gentleman's unique facial needs. This facial addresses skin that may be irritated from shaving, environmental or emotional stressors and provides mustache and beard moisturization.

Back Facial

60 Minutes - \$200 / \$180; 90 Minutes - \$290 / \$260

The Back Facial nurtures that area of the body most difficult to reach on one's own. The back is provided with a deep cleanse that purifies the skin and prepares it for treatment as identified by your esthetician through a thorough consultation.

FACIAL ENHANCEMENTS

May add to any facial treatment. Facial Enhancements may increase session length. Please verify at time of booking.

\$10 - \$30

Hydrating Treatments Masks: Eye, Face, Neck, Decollete
Manuka Honey Intensive Hydration Treatment
Kombucha Mask
Micronized Algae Treatment
Extractions
Intensive Eye Treatment
Exfoliating and Hydrating Lip Treatment
LED Light Therapy
NuFace Lifting and Toning targeted session

WAX SERVICES

15-60 Minutes \$18 - \$105

Back, Brow, Chin, Lip, Arm, Half Leg, Whole Leg, Bikini, Bikini Plus, Brazilian

TREATMENT ADD-ONS

May add to any facial or massage treatment. Add-ons may increase session length. Please request at time of booking.

\$20-\$30 each

Hand or Foot Quench
Targeted Back Exfoliation
Lip Exfoliation and Hydration Treatment
Hydrating Scalp Treatment
Cooling Eye Treatment

MASSAGE THERAPY

Custom Massage

30 Minutes - \$90; 60 Minutes - \$180 / \$160

90 Minutes - \$270 / \$240; 120 Minutes - \$360 / \$320

Our highly skilled massage technicians offer their unique set of skills. Prior to your session, you and your technician will tailor a treatment plan to address your individual physical concerns and preferences thus ensuring the most beneficial, healing and relaxing experience. Modalities our technicians may offer include Swedish, Deep Tissue, Trigger Point, Hot Stones, Reflexology, Reiki, Aromatherapy, Myofascial Release and more.

Ayurvedic Facial Massage

30 Minutes - \$90; 60 Minutes - \$180 / \$160

A lifting and toning massage targeting the muscles of the forehead, eyes, cheeks, jaws and neck precede the application of a hydrating and nourishing face mask treatment. Add LED light Therapy or a NuFace Treatment for additional lifting and toning benefits. An increase in cost may apply.

Probiotic Massage

30 Minutes - \$90; 60 Minutes - \$180 / \$160

90 Minutes - \$270 / \$240; 120 Minutes - \$360 / \$320

Improves the condition of the skin with peptide-rich probiotics to refine and smooth, antioxidants to alleviate the appearance of aging and ease wrinkles and deeply hydrating organic shea butter to seal in moisture.

In-Suite Tranquility

60 Minutes - \$250 / 90 Minutes - \$325 / 120 Minutes - \$425

Find your deepest level of relaxation with a customized individual or couples style massage provided in your guest room. A detoxifying, aromatherapy-enhanced bath is drawn at the end of your treatment, leaving you to enjoy a blissful sensorial soak.

Alpine Arnica Body Treatment

60 Minutes - \$205; 90 Minutes - \$295

Created especially for athletes, yogis, cellulite reduction and stress relief, this intensive deep tissue treatment is designed to focus on relaxing sore muscles, reducing tissue adhesions and congestion.

Prenatal Massage

30 Minutes - \$90; 60 Minutes - \$180 / \$160;

90 Minutes - \$270 / \$240

A gentle and nurturing experience for the expecting mother. Our prenatal massage technicians will focus on the muscular ailments generally associated with the effects of pregnancy while offering a safe and blissful experience for both mother and child. This service is offered in the 2nd and 3rd trimesters only.

Restorative Four-Handed Massage

30 Minutes - \$200; 60 Minutes - \$400

MASSAGE ENHANCEMENTS

\$25 each

Basalt Hot Stones
Himalayan Salt Hot Stones
Deep Tissue
Antara CBD Oil (\$30)

BODY RITUALS

Ultimate Zen

120 Minutes - \$345

This luxurious body ritual includes an ultra-hydrating full body exfoliation, body wrap and hot-oil scalp treatment followed by a relaxing and hydrating shea butter massage tailored with your favorite aroma. Your skin will retain its radiance for days.

Cashmere Quench

60 Minutes - \$200; 90 Minutes - \$270

Treat yourself to a full body exfoliation and a deeply moisturizing body wrap while enjoying a relaxing scalp massage followed with an application of probiotic-enhanced lotion.

Lemon Verbena Hydrating Body Treatment

60 Minutes - \$200; 90 Minutes - \$270

A two-step body polish and hydrating wrap, this body treatment leaves skin radiant and deeply nourished. Following the scrub, the body is drenched in a soothing and smoothing treatment to promote deep hydration.

Moisture Drench Body Wrap

60 Minutes - \$200; 90 Minutes - \$270

The ultimate skin conditioning treatment for the body. This session begins with a hypnotic massage, layering a warm, mineral-rich seaweed serum infused with aromatic Japanese ume plum extracts to revitalize the skin and is followed by a detailed massage with our sea fennel massage wax to deeply seal in moisture for a silky, satiny finish.

ENERGETIC OPTIONS

Reiki or Reflexology

30 Minutes - \$90 / 60 Minutes - \$180

Modalities that work with the body's energetic centers or reflex points help combat the effects of stress while also assisting the body's efforts to restore homeostatic balance both physically and emotionally. For more information about the above artforms, please contact The Spa.

FOOT RITUALS

The Ivy Signature Foot Ritual 60 Minutes - \$120

Tailored with your favorite aroma, our signature foot ritual begins with a soothing foot soak to alleviate sore, tired muscles and Himalayan salts to aid in the detoxification and remineralization of the body. Gentle exfoliation is provided with a hydrating sugar, salt and shea infusion. A foot and lower leg massage completes the ritual.

The Hot Toddy Foot Ritual 60 Minutes - \$160

Our hydrating, organic sugar scrub is created fresh for every treatment and enhanced with your scotch of choice. The Hot Toddy Foot Ritual begins with a relaxing foot soak in birch-infused bath flakes. Enjoy a delicious dram of scotch while you soak, fully immersing yourself into the experience. The treatment continues with a fragrant and skin softening exfoliation, lower leg and foot trigger point therapy and finishes with a hot stone massage over the lower legs and feet.

IVY PACKAGES

Perfect Petite Retreat 150 Minutes - \$425 / \$360

Transport the body and mind to a state of perfect bliss with a luxurious blend of services including a 60 minute customized facial and a 90 minute aromatherapy-infused signature massage.

Ivy Spa Lunch Retreat 60 Minutes - \$200 weekday / \$225 weekend

Relax with a 60-minute Custom Facial or Custom Massage. Enjoy a light snack and a glass of champagne upon completion of your service. Choose from either crudités or cheese board.

*All prices include gratuity

* Prices noted as X / X denote peak / off-peak

IVY SPA MEMBERSHIP PROGRAM

Become a Spa Member and receive a multitude of health and wellness benefits inclusive of but not limited to the following:

- 20% off any additional massage, body treatment or facial booked within the same monthly period
- 20% off your retail purchases every day
- 60-minute monthly massage, body treatment or facial service with your \$159 member commitment (4 month minimum commitment, after which, membership is month to month)
- Gratuity and Valet Parking are included
- Monthly Member Treatment and Retail Specials
- 10% off your guest room reservation at The Ivy Hotel

GROUPS

The Spa is the perfect venue for bridal and baby showers, wellness-centered bachelor or bachelorette parties, birthday celebrations, corporate retreats or family gatherings.

Spa service packages are customized specifically for your group. A bottle of champagne and 20% off your party's retail purchases are added group benefits. Contact The Spa for more details.

RETAIL OFFERINGS

Come visit the retail boutique inside The Spa At The Ivy and discover our offerings in luxury skincare, organic body care and natural health and wellness solutions. Some of our lines include:

Naturopathica is a natural skin and body care line that focuses on the health and well-being of skin and body by offering not only skin and body care solutions but also incorporate teas, tinctures and holistic wellness education

Restorsea - Naturally derived and clinically proven. Backed by clinical trials, the Restorsea line is anchored by a revolutionary, proprietary enzyme called Aquabeautine XL®, which gently exfoliates to minimize visible signs of aging without harsh side effects and reduces the appearance of hyperpigmentation.

Zents - Body care with organic and clean ingredients. Globally and locally sourced. Always vegan, gluten- and cruelty- free.

NuFACE and NuBODY - NuFACE helps improve facial contours and reduces while NuBODY helps tone and firm body skin while smoothing away the look of dimples.



THE SPA AT THE IVY HOTEL

205 EAST BIDDLE STREET, BALTIMORE, MARYLAND 21202

410-514-6180 theivybaltimore.com spa@theivybaltimore.com





DINING

BREAKFAST

Breakfast is served from 7:00AM to 10:00 AM in Magdalena's Garden Room. You will find a Breakfast Menu in the menu section of the compendium.

LUNCH/ROOM SERVICE

You may order from the Room Service Menu which can be viewed in the menu section. During restaurant hours, dinner from Magdalena can be served in your room.

AFTERNOON TEA AT THE IVY

A sumptuous afternoon tea is served daily from 2:00 PM to 4:00 PM in the first floor public rooms, and showcases the exceptional blends and uniquely aged gourmet teas supplied by The Rare Tea Cellars of Chicago. Teas from around the world are accompanied by a cream tea, proudly prepared by our talented culinary team. Hot beverages are available for guests any time of day.





MAGDALENA, A MARYLAND BISTRO

Intimate and informal, Magdalena is a public restaurant on The Ivy's ground floor where dinner is served Tuesday through Saturday from 5:00 to 9:00 PM. Featuring thoughtfully created bistro fare inspired by the classic dishes of France, the comforts of England and the vast spirit of Baltimore, Magdalena pays tribute to European traditions infused with Maryland soul. The menu changes with the seasons and the inspiration of the chef. A current menu is available at the Concierge Desk.

Begin your evening at the Bar, where in addition to the customary libations and creative house cocktail specialties, there's also an impressive array of the finest malt whiskeys, and some of the best craft beers anywhere. Afterwards, choose to dine in one of Magdalena's four dining rooms, each with its own special ambiance: the Garden Room, which overlooks The Ivy's walled courtyard, or in the intimate, candle-lit and romantic Treasury, the cozy Tasting Room, or the vaulted, brick-floored Wine Cellar, a handsome dining area particularly well-suited to friends gathering for a delicious and intimate dinner together.

WINE CELLAR

The Robert M. Parker Wine Cellar is named in honor of the world's foremost wine authority, a native Baltimorean and a frequent guest at the restaurant. We are very proud to be the only wine cellar in the world to be permitted to use Mr. Parker's name. The focus of the Cellar is superb small production American wines, although The Ivy also has a broad selection of unique wines from around the world, as well as dozens of 100 point wines. Since opening in 2015, Magdalena has won four consecutive Wine Spectator awards for its carefully curated wine selections. Please contact us to view the wine list.





CHEF MARK LEVY

Mark Levy is a classically trained, award-winning chef, born in Britain and a long-standing veteran of haute cuisine. Levy has a reverent regard for flavor, texture, color, even the temperature of foods - and an explorer's passion and energy for preparing them. He has traveled the world exploring cultures and cuisines. High-quality seasonal foods are at the forefront of the Magdalena menu – simple ingredients in thrilling combinations, all prepared with Levy's easy panache.



BREAKFAST MENU

Breakfast is served daily from 7am to 10am

Enjoy freshly baked croissants served with preserves & honey butter.

Two Local Eggs

Any way you like them served with Red bliss potatoes, Toast and Choice of Protein
Maryland Ham, Country Sausage, Smoked Bacon, Turkey Bacon, Chicken & Apple Sausage,
Lamb Merguez

Eggs Benedict

Either Chesapeake Crab Cake, Maryland Ham or Florentine. Served on English Muffin with
Hollandaise Sauce

Lemon & Ricotta Pancakes

Two Griddled Fluffy Pancakes, Topped with a Huckleberry Berry Compote & Whipped
Cream

Smoked Salmon Salad

Whiskey Smoked Irish Salmon Served on Baby Gem Lettuce, Local Feta Cheese, Cucumber,
Pine Nuts & Dill with a Citrus Vinaigrette

Also Available;

Hot Oatmeal

Boiled Eggs & Soldiers

Marinated Fresh Seasonal Fruit

French Style Omelets

Homemade Granola with Greek Yogurt with Berries

Teas & Coffees

Cappuccino, Late, Macchiato or Drip

Lapsang Souchong, English Breakfast, Chamomile Citron, Earl Grey, Mint Meritage

Toast; Brioche, White, Multigrain

Early Departure Breakfast, Before 7am

Hot Beverage & Juice or Water

Warm Croissants

Marinated Fruit

French Yogurt



ROOM SERVICE MENU

Available Tuesday through Saturday from 12pm – 10pm

Sunday and Monday from 12pm – 9 pm

LATE NIGHT MENU: All *asterisked items are available until 4am

Salads & Snacks

*House Green Salad, Seasonal Vinaigrette \$18

*Soup Du Jour \$15

House Favorites

Southern Maryland Ham, Pickles, Mustard & Grilled Bread \$18

Local Jumbo Lump Crab Cake, Cocktail Sauce & Slaw \$40

*Classic Triple Decker Boar's Head Turkey Club, Served on Toasted Brioche \$25

44 Farms Dry Aged Cheeseburger on a Brioche Bun, French Fries \$28

Steak Frites, 8oz Prime Flank Steak, French Fries & Homemade A-1 sauce \$35

Fettuccini, Garden Basil Pesto, Roasted Mushrooms & Tomato \$18 App \$36 Entree

Artisanal Cheese Board, Three Cheeses, House Chutney, Grapes & Crackers \$25

Desserts

Chocolate & Passion Fruit Tart \$ 15

Rocky Road Sundae \$15

Sorbets & Ice Creams \$15

*Selection of Cookies and Brownies, Served with a Glass of Ice-Cold Milk \$12





BALTIMORE ATTRACTIONS

There is so much to see and do in Charm City; destinations listed here are but a sampling. Baltimore is unlike any other city in North America: vibrant, friendly, historic, compact, quirky, and a truly fascinating amalgam of more than 200 neighborhoods, each with a unique character and history.

The Ivy's Mt. Vernon neighborhood is a National Landmark Historic District, one of America's most beautiful urban areas, and home to some of the most historically significant and well-preserved 19th century buildings in the U.S. It is also the city's cultural center, and many museums, opera and concert halls, libraries, colleges, and theatres are within easy walking distance.

Every week there are a wealth of live performances of music of all kinds, theater, dance, fairs and festivals, workshops and seasonal events. An online arts and culture calendar, culturefly.org/calendar provides a comprehensive overview of current events in the region.

To help you take full advantage of your time in Baltimore, we will happily provide more information on the the options listed below, let you know about special events and performanc- es, and arrange for tickets and transportation.

ART

AMERICAN VISIONARY ART MUSEUM

Billed as "America's official national museum and education center for intuitive, self-taught artistry" and specializing in the preservation of outsider art, AVAM features a wide range of exhibits that celebrate individualized and spontaneous art demonstrating an innate and very personal vision. Visiting AVAM is a joyful, exhilarating experience. Restaurant Encantada serves '21st century' locally sourced mid-Atlantic fare during museum hours (except Tuesday). 800 Key Highway
Phone: (410) 244-1900





THE BALTIMORE MUSEUM OF ART

Visitors to the BMA can enjoy extraordinary exhibits of 19th-century, modern, and contemporary art. Founded in 1914, the Baltimore Museum of Art features the internationally renowned Cone Collection - artworks collected by the Cone sisters during their time in Europe in the early 20th century, and which includes the world's largest number of works by Henri Matisse. While there, visit the Sculpture Garden and Gertrude's Restaurant specializing in Chesapeake Bay cuisine. Admission is free, although there may be a charge for some special exhibits.

10 Art Museum Drive

Phone: (443) 573-1700

THE GEORGE PEABODY LIBRARY

The Peabody Library, though it houses a 19th century-focused research library of Johns Hopkins University, is primarily an architectural destination for most visitors. Opened in 1878, the strikingly impressive Stack Room consists of five tiers of ornamental cast-iron balconies rising dramatically over sixty feet to the skylight, in jaw-droppingly beautiful Renaissance Revival style. The Walters Art Museum, listed below, is across the street.

17 East MountVernon Place

Phone: (443) 840-9585

WALTERS ART MUSEUM

A short walk from The Ivy is an world-renowned collection of thousands of treasures ranging from the 3,000 B.C. to early 20th century Europe, a collection amassed by father and son William and Henry Walters, who bequeathed the mansion and its contents to the city. Noted collections include Egyptian, Greek, Roman, Byzantine, Ethiopian, and western Medieval art, antiquities and artifacts, as well as Renaissance and Asian art. With advance notice, a docent tour of the collection can be arranged.

600 North Charles Street

Phone:(410) 547-9000





FAMILY & SCIENCE

MARYLAND SCIENCE CENTER

Opened in 1976, the MD Science Center is an excellent destination for families. Located on the city's inner harbor, the three floors of hands-on exhibits are interactive, creative, and very engaging. Other attractions include an IMAX theater, a vaulted Dinosaur Hall, Newton's Alley, Space Link Gallery, a Science Lab, Planetarium shows, an Observatory, Kids Room, Science Store, and a new cafe.

601 Light Street

Phone: (410) 685-5225

MARYLAND ZOO

The 160-acre, fully accredited Maryland Zoo, founded in 1876, is the third oldest in the U.S. Located in Druid Park, only three miles from The Ivy, the Zoo is a splendid family destination. Penguin Coast is not only a new and state-of-the-art exhibit, but the largest collection of African penguins in the US and the most successful breeding colony in North America. Other popular favorites are the Polar Bear Watch, the Giraffe Feeding Station, Jones Falls Zephyr Train Rides, and Samson the Elephant.

1876 Mansion House Drive

Phone (410) 396-7102

NATIONAL AQUARIUM

Located in Baltimore's Inner Harbor, the National Aquarium takes visitors into the fascinating realm beneath the surface of the world's oceans and is guaranteed to mesmerize both children and adults and fill them with a sense of wonder. Featuring plant life and almost 20,000 aquatic animals from around the world, attractions include a multi-level coral display, a Living Seashore Touch Exhibit, Shark Alley, a Tropical Rainforest, Australia and behind the scenes 'Insider' tours. Depending on the time of your visit, visitors can enjoy a dolphin show or a show at the 4D Immersion Theater.

501 East Pratt Street

Phone: (410) 576-3800





PORT DISCOVERY

Located in the heart of downtown Baltimore, adults and children two to ten years old are invited to ‘play with a purpose’, and enjoy interactive, hands on learning about science and life skills on three floors rich with educational programs, special events, and permanent and visiting exhibits.

35 Market Place

Phone: (410) 727-8120

HISTORY

BALTIMORE & OHIO RAILROAD MUSEUM

A National Historic Monument, the forty acre campus is on the site of the birthplace of American railroading, where the first commercial long distance tracks were laid. It houses the oldest and most complete collection of American railroad artifacts in the world, including locomotives, rolling stock, exhibits and historic buildings. Combination tickets are available to Ellicott City Station in Ellicott City, and Mount Clare Museum House, the oldest colonial Georgian house in the city.

901 Pratt Street

Phone: (410) 752-2490

FORT MCHENRY NATIONAL MONUMENT & HISTORIC SHRINE

Discover the 18th century brick fort where the battle occurred that served as inspiration for the American National Anthem. Now part of the National Parks Service, Fort McHenry was vital during the War of 1812, protecting Baltimore’s Inner Harbor from a British invasion in 1814. Imprisoned on a ship in the harbor, attorney Francis Scott Key watched the bombardment and wrote a poem commemorating the American triumph. Daily activities include participatory demonstrations led by park rangers.

2400 East Fort Avenue

Phone:(410) 962-4290





HISTORIC SHIPS OF THE INNER HARBOR

Four Historic Ships that include the USS Constellation, America's last all-sail naval vessel, and the USS Torsk submarine, are anchored in Baltimore's Inner Harbor and document life at sea from the mid-19th century to the 1980's. Enjoy a walk down the promenade, see excellent views of the city, and climb aboard some of these treasures.

301 East Pratt Street

Phone: (410) 539-1797

JONESTOWN "OLD TOWN"

Nine historic sites are located in this oldest of Baltimore's neighborhoods, including the Star Spangled Banner Flag House, the Friends Meeting House (the city's oldest religious structure), and the Reginald F. Lewis Museum, the largest African American museum in the U.S. Contact the Concierge for more details, hours, and locations of individual sites.

MARYLAND HISTORICAL SOCIETY

Since 1844, The Maryland Historical Society Museum and Library has been preserving hallmarks of both American and Maryland history. Exhibitions use historic artifacts to help visitors explore the diverse heritage that has shaped Baltimore and the United States. While there, be sure to check out the original copy of "The Star Spangled-Banner," the poem that would become the nation's national anthem, as well as several of Edgar Allan Poe's original manuscripts. 201 West Monument Street

Phone: (410) 685-3750





OTHER ATTRACTIONS

ORIOLE PARK AT CAMDEN YARDS

Any time of year is a great time to visit Camden Yards, home to Baltimore's MLB team, the Orioles. Situated near the Inner Harbor, it opened in 1992, and was the first 'retro' ballpark and still the most highly praised of the baseball-only stadiums. Rather than demolish a long narrow 19th century B&O warehouse adjacent to the park, the building was incorporated into the design and now houses offices, service areas, and a private club. Like The Ivy Hotel, this is another great example of Baltimore utilizing its historic buildings for modern day use. Let us help you book a tour, and ask about catching a home game from April-September. Post-season play is always anticipated!

333 West Camden Street

Phone: (888) 848-BIRD

BABE RUTH BIRTHPLACE MUSEUM

Three blocks west of Oriole Park is the tiny brick rowhouse, where George Herman Ruth, America's first sports superstar, was born on February 6, 1895. The museum has expanded into three adjoining tenement houses to house exhibits and memorabilia documenting the larger-than-life persona of the man variously known as 'The Sultan of Swat', 'The Caliph of Clout', The Bambino, and of course, The Babe.

216 Emory Street

Phone: (410) 727-1539

HORSESHOE CASINO

Opened in 2014, the Horseshoe Casino features table games, slot machines, restaurants, and live entertainment, as well as a World Series of Poker room. Located near Camden Yards and M&T Bank stadium, the casino is open 24 hours a day, every day of the year.

Reminder: one must be 21 years of age to gamble in the state of Maryland.

1525 Russell St, Baltimore 21230

Phone: (844) 777-7463





HOWARD PETERS RAWLINGS CONSERVATORY & BOTANIC GARDENS

Located in Druid Hill Park, the Conservatory is an appealing destination for visitors any time of year. The splendid, soaring 1886 Palm House was designed by the noted architect George A. Frederick, who also designed Baltimore City Hall. It is the last in a series of conservatories that once existed in every Baltimore City park, and is the second oldest surviving glass botanic conservatory in the US. Two pavilions added in 2002 contain the Orchid Room, and the Mediterranean, Tropical, and Desert Houses.

3100 Swann Drive

Phone: (410) -396-0008

SHOPPING

We will be happy to put together a shopping itinerary that suits your tastes and needs, whether boutique and intriguing locally-owned shops in nearby Fells Point, Harbor East, and Hampden, or to destinations somewhat farther afield. Most of the museums listed in the compendium have eclectic and appealing shops for one of a kind quirky treasures.

